



2011 Catalog

## Table Of Contents

<i>Aluminum Products</i> .....	3-7
Introduction .....	3
MerCruiser V6 Manifold .....	4
MerCruiser V8 Big Block Manifold .....	5
MerCruiser V8 Small Block Manifold .....	6
MerCruiser V6, V8 Center Riser .....	7
<i>Generic</i> .....	8-10
GM Small Block V8 Manifold .....	8
Ford Small Block V8 Manifold .....	9
Riser .....	10
<i>MerCruiser</i> .....	11-18
V6 Manifold .....	11
V8 Big Block Manifold .....	12
V8 Small Block Manifold .....	13
V6, V8 Center Riser .....	14
Straight 6 Log Style Manifold .....	15
V8 Log Style Manifold .....	16
Log Style Riser .....	17
4 Cylinder Elbow / Reservoir .....	18
Oval Elbow .....	18
<i>OMC/2.3L Engine Thermostat Housing</i> .....	19
<i>OMC/Volvo</i> .....	20-23
GM V8 Small Block Manifold .....	20
GM V6 Manifold .....	21
GM V8 Center Riser .....	22-23
<i>Volvo Penta</i> .....	24-29
GM V8 Small Block Manifold .....	24
GM V8 Small Block Center Riser .....	25
V6 In-line Manifold .....	26
4 Cylinder Manifold and Riser .....	27
GM V6 Manifold and Riser .....	28-29
<i>Volvo Penta Diesel Elbows</i> .....	30
<i>Yanmar and Detroit Diesel Elbows</i> .....	31
<i>Accessories</i> .....	32-37
End Plate, Spacer .....	32-33
Tube, Damper Plate .....	34
Engine Mount / Bell Housing / Water Fittings .....	35-37
<i>Products Under Development</i> .....	38-45
<i>Installation Examples</i> .....	46-51
Center Riser Manifold (Open System, Closed System) .....	46
Log Style Manifold (Open System) .....	47
Log Style Manifold (Closed System Option 1) .....	48
Log Style Manifold (Closed System Option 2) .....	49
Log Style In-line 6 Manifold .....	50-51

## Aluminum Products - Introduction

### HIGHLIGHTS OF THE 356-T6 ALUMINUM ALLOY MANIFOLD:

#### 1. WHAT DOES “LPC” STAND FOR?

- A. “LPC” or “Low Pressure Casting” is a casting method that uses the pressure of inert gas to force the molten liquid metal from the bottom of the holding pot through a riser pipe into the tooling mold directly above.
- B. After the casting cools and solidifies, the pressure is reduced.
- C. The pressure applied usually does not exceed 1.0 bar, hence “low pressure casting”.

#### 2. WHY IS “LPC” SUPERIOR TO “LOST FOAM” CASTING?

- A. The technology of “Lost Foam” casting is carried out by gravitational force (0.0689 bar, 1 atmosphere pressure) while LPC is done by pressurizing the molten liquid metal, usually at around 0.3 ~ 0.8 bar, 4.35~11.6 atmosphere pressure.
- B. LPC can be carefully controlled to eliminate porosity in the casting wall. This is because the molten metal becomes denser as it is squeezed into the mold by pressure, thus preventing gas bubbles and inclusions. The results are as superior as those produced by forging (manifolds can not be produced by forging).
- C. The LPC method allows for improved filling of thin-walled parts and large areas of tooling.

#### 3. WHY CHOOSE 356-T6 ALLOY AND POWDER COAT FOR HGE MANIFOLDS?

- A. To prevent the manifold and the riser elbow from being corroded by its saline environment.
- B. The shiny powder coating not only enhances the attractiveness of the surface, but also increases the longevity of the manifold.

#### 4. WHY ARE ALUMINUM ALLOY MANIFOLDS MORE PREFERABLE THAN CAST IRON?

- A. The persistent problem of corrosion can be overcome.
- B. The weight of the traditional cast iron manifold and is greatly reduced (aluminum is 1/5<sup>th</sup> the weight of iron).
- C. The cost of iron ore remains high due to the demand from heavy construction, but demand for aluminum ore has been steadily declining. Aluminum is more economical.

#### 5. ALUMINUM MANIFOLDS MYTHS

- A. Myth 1: It acts like an anode!  
**Not true.** The 356-T6 alloy is common; evidenced by the many large and small aluminum boats in the marina.
- B. Myth 2: The manifold will warp easily!  
**Not true.** If the aluminum manifolds have good water cooling, they are an excellent heat conductive material. In nearly all automobiles today, aluminum is used for the engine head, intake manifold and engine block to reduce weight. Also, bear in mind the car engine runs 40 ~ 60 degrees F hotter than the boat engine.

## Aluminum Products - MerCruiser V6 Manifold



Replaces:  
 Aqua Power# 5505  
 Barr# MC-1-99746  
 GLM# 51220,51225  
 Marine Power# 0996-000  
 MerCruiser# 99745  
                   99746  
 Osco# 9745  
 Sierra# 18-1952-1

### HGE 9746-A MerCruiser V6 Manifold – Aluminum (with mounting kit)

This manifold fits MerCruiser GM V6 229 cu.in. and 262 cu.in. engines Model 185R, 185MR, 205R and 205MR.

Risers	
HGE 4354-A	4" exhaust outlet, 7° down angle center riser (Aluminum)

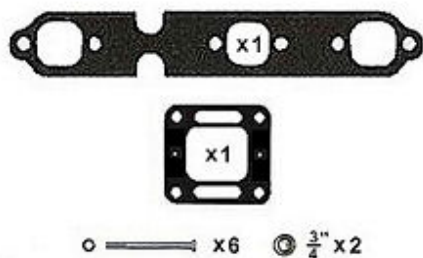

#### Mounting Kit # HGE9746-AMK

Content	Qty
Manifold Gasket HGE 99757	1
Riser Gasket (restrictor) HGE 41813	1
Bolt 3/8" 16UNC x 5"	6
+ Washer	6
Aluminum Plug 3/4" NPT	2

## Aluminum Products – MerCruiser V8 Big Block Manifold



Replaces:  
 Aqua Power# 5506  
 Barr# MC-1-89011  
 GLM# 51240,51245  
 Marine Power# 0991-100  
 MerCruiser# 89011  
                     807078  
 Osco# 9011  
 Sierra# 18-1957-1

### HGE 9011-A MerCruiser V8 Big Block Manifold – Aluminum (with mounting kit)

This manifold fits MerCruiser GM V8 Big Block engines Models 330, 340 and 454 Magnum Inboard and stern-drive unit.

Risers	
HGE 4354-A	4" exhaust outlet, 7° down angle center riser (Aluminum)



#### Mounting Kit # HGE9011-AMK

Content	Qty
Manifold Gasket HGE 46820	1
Riser Gasket (restrictor) HGE 41813	1
Stud $\frac{3}{8}$ " 16UNC x $1\frac{3}{4}$ "	8
+ Nut	8
+ Washer	8
Aluminum Plug $\frac{3}{4}$ " NPT	2

## Aluminum Products – MerCruiser V8 Small Block Manifold



Replaces:  
 Aqua Power# 5500  
 Barr# MC-1-87114  
 GLM# 51230, 51235  
 Marine Power# 0994-100  
 MerCruiser # 87114  
                     860246  
 Osco# 7114B2  
 Sierra# 18-1953-1

### HGE 7114-A MerCruiser V8 Small Block Manifold – Aluminum (with mounting kit)

This manifold fits MerCruiser GM Small Block V8 305 - 350 cu.in. engine Models 220, 228, 230, 260 and 898.

Risers	
HGE 4354-A	4" exhaust outlet, 7° down angle center riser (Aluminum)



#### Mounting Kit # HGE7114-AMK

Content	Qty
Manifold Gasket HGE 0000	1
Riser Gasket (restrictor) HGE 41813	1
Bolt $\frac{3}{8}$ " 16UNC x 5" + Washer	4
Aluminum Plug $\frac{1}{2}$ " NPT	1
Aluminum Plug $\frac{3}{4}$ " NPT	2

## Aluminum Products – MerCruiser V6, V8 Center Riser



Replaces:  
 Aqua Power# 5706  
 Barr# MC-20-44354  
 GLM# 55140,51145  
 Marine Power # 0992-400  
 MerCruiser# 44354  
                   807914  
                   807988  
 Osco# 4354  
 Sierra# 18-1976-1

### HGE 4354-A MerCruiser Center Riser – Aluminum (with mounting kit)

4" exhaust outlet, 7° down angle.

The riser fits to following manifolds:

Manifolds	Engines
HGE 9011-A (MC-1-89011)	<b>MerCruiser GM V8</b> big block Models 330, 340 and 454 Magnum Inboard and stern-drive units.
HGE 7114-A (MC-1-87114)	<b>MerCruiser GM V8</b> small block 228R, 260R, 898R
HGE 9746-A (MC-1-99746)	<b>MerCruiser GM V6</b> 229 and 262 cu. in. Model 185R, 185MR, 205R and 205MR

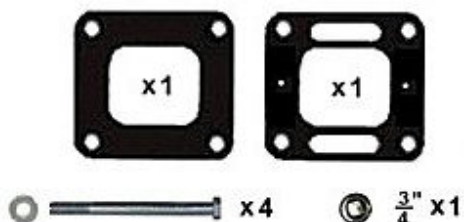

#### Mounting Kit # HGE4354-AMK

Content	Qty
Riser Gasket (close) HGE 41811	1
Riser Gasket (restrictor) HGE 41813	1
Bolt $\frac{3}{8}$ " 16UNC x 5 $\frac{1}{2}$ "	4
+ Washer	4
Aluminum Plug $\frac{3}{4}$ " NPT	1

**Generic Center Riser Style Manifold – GM Small Block V8**



Replaces:  
Aqua Power# 5517  
Barr# CHV-1-83  
GLM# 56230  
Marine Power# 0994-000  
Osco# 994  
Sierra# 18-1997-1

**HGE 1-83**  
**GM Small Block V8 Center Riser Style manifold**  
**(with mounting kit)**

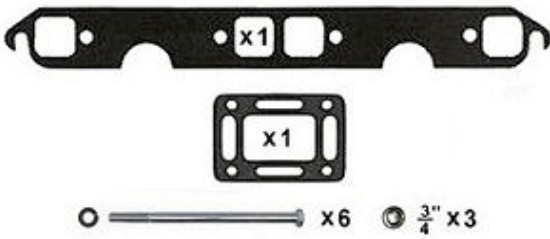
	<b>Mounting Kit # HGE 1-83MK</b>	
	Content	Qty
	Manifold Gasket HGE 0000	1
	Riser Gasket (open) HGE 10107	1
	Bolt 3/8"-16UNC x 3 1/2"	6
	+ Lock Washer	6
	Steel Plug 3/4" NPT	3

**Generic Center Riser Style Manifold - Ford Small Block V8**

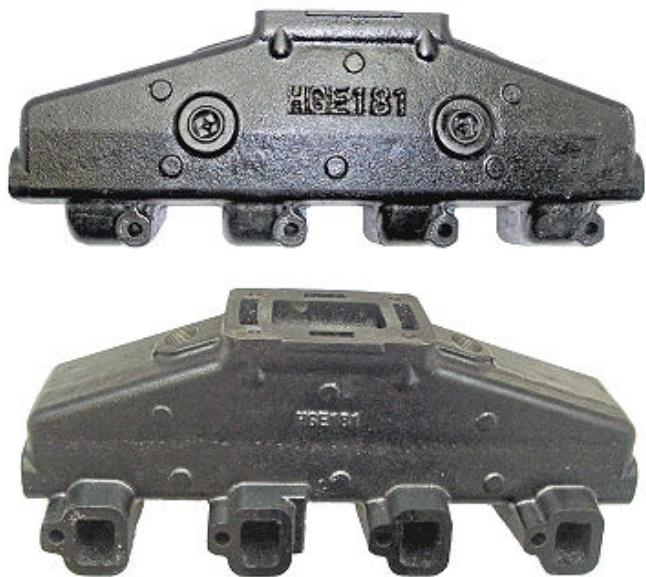

Replaces:  
Aqua Power# 5517  
Barr# FM-1-83  
GLM# 56250  
Osco# FL-994  
Sierra# 18-1998-1

**HGE 1-81**  
**Ford Center Riser Style V8 Manifold (with mounting kit)**

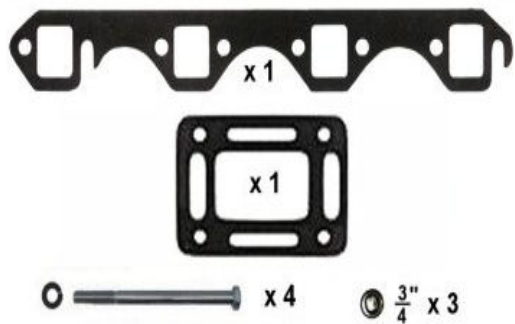

**Mounting Kit # HGE 1-81MK**

Items	Qty
Manifold Gasket HGE 10001	1
Riser Gasket (open) HGE 10107	1
Bolt 3/8"-16UNC x 3 3/4"	4
+ Lock Washer	4
Steel Plug 3/4" NPT	3

# Generic – Center Riser



Replace:  
Aqua Power# 5705  
Barr# 20-0082  
GLM# 56110  
Marine Power# 0992-000  
Osco# 992  
Sierra# 18-1999

## HGE 0082 Center Riser (with mounting kit)

3" outlet, 10° down angle. Use 3" i.d. flexible exhaust hose which facilitates connection to existing exhaust pipes.

The riser fits to following manifolds:

Manifolds	
HGE 1-81 , HGE 1-83	
Barr CHVA-1-84 , CHV-1-83, FM-1-83	
Osco 994, FL994, CW994	

Mounting Kit # HGE 0082MK	
Content	Qty
Riser Gasket (open) HGE 10107	1
Riser Gasket (close) HGE 10105	1
Stud 3/8" x 1 3/4"	4
+ Nut	4
+ Lock Washer	4
Steel Plug 3/4" NPT	1

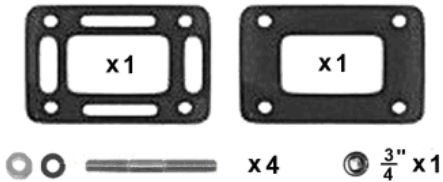

**MERCRUISER – V6 Manifold**



Replaces:  
Aqua Power# 5505  
Barr# MC-1-99746  
GLM# 51220  
Marine Power# 0996-000  
MerCruiser# 99745  
99746  
Osco# 9745  
Sierra# 18-1952-1

**HGE 9746  
MerCruiser V6 Manifold (with mounting kit)**

This manifold fits MerCruiser GM V6 229 cu.in. and 262 cu.in. engines. Model 185R, 185MR, 205R and 205MR.

Risers	
HGE 4354	4" exhaust outlet, 7° down angle center riser
MC-20-98504	3" exhaust outlet, 15° down angle center riser

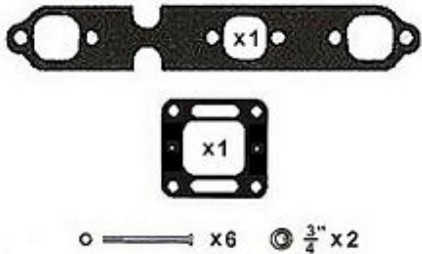

**Mounting Kit # HGE 9746MK**

Content	Qty
Manifold Gasket HGE 99757	1
Riser Gasket (restrictor) HGE 41813	1
Bolt 3/8"-16UNC x 5"	6
+ Lock Washer	6
Steel Plug 3/4" NPT	2

## MERCRUISER – V8 Big Block Manifold



Replaces:  
 Aqua Power# 5506  
 Barr# MC-1-89011  
 GLM# 51240  
 Marine Power# 0991-100  
 MerCruiser# 89011  
                     807078  
 Osco# 9011  
 Sierra# 18-1957-1

### HGE 9011 MerCruiser V8 Big Block Manifold (with mounting kit)

This manifold fits MerCruiser GM V8 Big Block Engine Models 330, 340 and 454 Magnum inboard and stern-drive unit.

Risers	
HGE 4354	4" exhaust outlet, 7° down angle center riser
MC-20-98502	3" exhaust outlet, 0° center riser
MC-20-98504	3" exhaust outlet, 15° down angle center riser

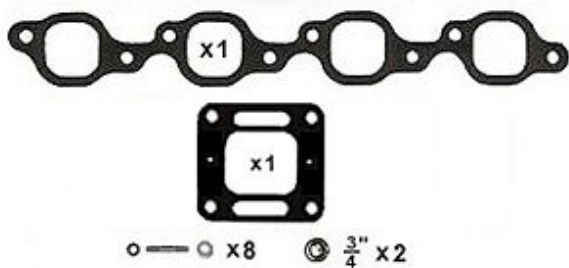

#### Mounting Kit # HGE 9011MK

Content	Qty
Manifold Gasket HGE 46820	1
Riser Gasket (restrictor) HGE 41813	1
Stud 3/8" x 1 3/4"	8
+ Nut	8
+ Lock Washer	8
Steel Plug 3/4" NPT	2

## MERCRUISER – V8 Small Block Manifold



Replaces:  
 Aqua Power# 5500  
 Barr# MC-1-87114  
 GLM# 51230  
 Marine Power# 0994-100  
 MerCruiser # 87114  
                   860246  
 Osco# 7114B2  
 Sierra# 18-1953-1

### HGE 7114 MerCruiser V8 Small Block Manifold (with mounting kit)

This manifold fits MerCruiser GM Small Block V8 305 - 350 cu.in. engines. Models 220, 228, 230, 260 and 898.

Risers	
HGE 4354	4" exhaust outlet, 7° down angle center riser
MC-20-98502	3" exhaust outlet, 0° center riser
MC-20-98504	3" exhaust outlet, 15° down angle center riser

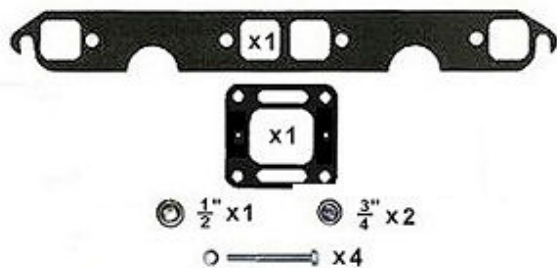

#### Mounting Kit # HGE 7114MK

Content	Qty
Manifold Gasket HGE 0000	1
Riser Gasket (restrictor) HGE 41813	1
Bolt 3/8"-16UNC x 5"	4
+ Lock Washer	4
Steel Plug 1/2" NPT	1
Steel Plug 3/4" NPT	2

## MERCRUISER – V6, V8 Center Riser



Replaces:  
 Aqua Power# 5706  
 Barr# MC-20-44354  
 GLM# 55140  
 Marine Power # 0992-400  
 MerCruiser# 44354  
                   807914  
                   807988  
 Osco# 4354  
 Sierra# 18-1976-1

### HGE 4354 MerCruiser Center Riser (with mounting kit)

4" exhaust outlet, 7° down angle.

The riser fits to following manifolds:

Manifolds	Engines
HGE 9011 (MC-1-89011)	<b>MerCruiser GM V8</b> Models 330, 340 and 454 Magnum Inboard and stern-drive units.
HGE 7114 (MC-1-87114)	<b>MerCruiser GM V8</b> 228R, 260R, 898R
HGE 9746 (MC-1-99746)	<b>MerCruiser GM V6</b> 229 and 262 cu. in. Model 185R, 185MR, 205R and 205MR

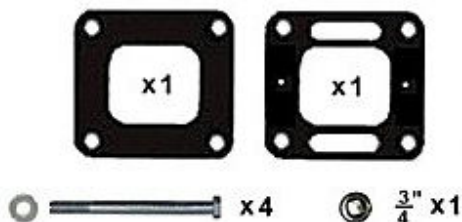

#### Mounting Kit # HGE 4354MK

Content	Qty
Riser Gasket (close) HGE 41811	1
Riser Gasket (restrictor) HGE 41813	1
Bolt 3/8" -16UNC x 5 7/8"	4
+ Lock Washer	4
Steel Plug 3/4" NPT	1

## MERCRUISER – Straight 6 Log Style Manifold



Replaces:  
 Aqua Power# 5528  
 Barr# MC-1-58759  
 GLM# 51224  
 Marine Power# 0995-000  
 MerCruiser# 58759  
 Osco# 8759

### HGE 8759 MerCruiser In-line 6 Manifold (with mounting kit)

This manifold fits MerCruiser Straight 6 cylinder 250 and 292 cu.in. engines. Model 165 and 200.

Risers	
HGE 6351	3" exhaust outlet, 90° down angle MerCruiser Log Riser (stern-drive).



#### Mounting Kit # HGE 8759MK

Content	Qty
Manifold gasket HGE 46401	1
End Gasket HGE 48043	2
Riser Gasket (open) HGE 52076	1
Carburetor Gasket HGE 58764	1
Stud 3/8" x 5 3/4"	6
+ Nut	6
+ Lock Washer	6

## MERCRUISER – V8 Log Style Manifold



Replaces:  
 Aqua Power# 5508  
                   5509  
 Barr# MC-1-77234 /  
           MC-1-77235  
 GLM# 51237 /  
           51238  
 Marine Power# 0999-710  
                   0999-712  
 MerCruiser# 77234B  
                   77235B  
 Osco# 7234B / 7235B  
 Sierra# 18-1950-1 /  
           18-1951-1

### HGE 7234 (port) / HGE 7235 (starboard) MerCruiser V8 Small Block Log Manifold (with mounting kit)

This manifold fits MerCruiser GM small block V8 305 - 350 cu.in. engines. Models 198, 228, 255, 260 and 898 inboard and stern-drive units.

Risers	
HGE 6351	3" exhaust outlet, 90° down angle riser (inboard/stern drive).
MC-20-76771	3" exhaust outlet, 0° angle riser (inboard).

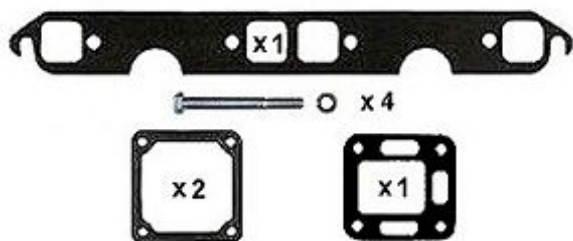

#### Mounting Kit # HGE 7234MK

Content	Qty
Manifold Gasket HGE 0000	1
End Gasket HGE 48043	2
Riser Gasket (open) HGE 52076	1
Bolt 3/8"-16UNC x 5"	4
+ Lock Washer	4

## MERCRUISER – Log Style Riser



Replaces:  
 Aqua Power# 5701  
 Barr# MC-20-60426  
           MC-20-76351  
 GLM# 51120  
 Marine Power# 0993-001  
 MerCruiser# 76351  
               60426  
               49964  
 Osco# 6351  
 Sierra# 18-1971

### HGE 6351 MerCruiser Log Manifold Riser (with mounting kit)

3" exhaust outlet, 90° down angle.

The riser fits to following manifolds:

Manifolds	Engines
HGE 7234 (MC-1-77234)/ HGE 7235 (MC-1-77235)	<b>MerCruiser GM Small Block V8</b> 305 - 350 cu. in. Models 198, 228, 255, 260 and 898 inboard and stern-drive units. (port: 0999-710 Starboard: 0999-712)
HGE 8759	<b>MerCruiser GM In-Line Six Cylinder</b> 250 and 292 cu. in. Model 165 and 200
MC-1-65603 / MC-1-65604	<b>MerCruiser Ford Small Block V8</b> 302 - 351 cu. in. Models 188, 215, 225, 233, 255 and 888 inboard and stern-drive units.
MC-1-52390	<b>MerCruiser 4 cylinder</b> 181 cu. in. 140 h.p. Model 140

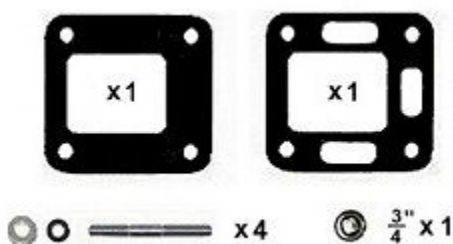

#### Mounting Kit # HGE 6351MK

Content	Qty
Riser Gasket (open) HGE 52076	1
Riser gasket (close) HGE 92720	1
Stud 3/8" x 1 3/4"	4
+ Nut	4
+ Lock Washer	4
Steel Plug 3/4" NPT	1

**MERCRUISER – 4 Cylinder Elbow / Reservoir**



Replaces:  
MerCruiser# 98562A6  
OSCO# 8561  
Sierra# 18-1937

**HGE 8561**  
**Elbow / Reservoir(with mounting kit)**

Fits following manifold:

Manifolds	Engines
MerCruiser 816219A5	MerCruiser 4 Cylinder engines. Model 165,170,180,190, 470 and 3.7L

	<b>Mounting Kit # HGE 8561MK</b>	
	Content	Qty
	Elbow/Reservoir Gasket HGE 88562	1
	Bolt $\frac{7}{16}$ "-14UNC x 4"	4
	+ Lock Washer	4
	Steel Plug $\frac{3}{4}$ " NPT	3
Brass Plug $\frac{1}{8}$ " NPT		1

**MERCRUISER – Oval Elbow**

	<p>MerCruiser Oval Elbow – 4" Aluminum Exhaust Tube</p> <p>Replaces: MerCruiser # 14478T01</p>
<b>HGE 4478-A</b>	

OMC 2.3L Engine Thermostat Housing



Replaces:  
OMC# 985470

**HGE 5470**  
**OMC 2.3L Engine Thermostat Housing (with mounting kit)**

Fits OMC 2.3L engines.	
Riser	
HGE 3784	Center riser, 4" exhaust outlet, 7° down angle.

	<b>Mounting Kit # HGE 5470MK</b>	
	Content	Qty
	Thermostat Housing Gasket HGE 912478	1
	Bolt 3/8"-16UNC x 3"	1
	Bolt 3/8"-16UNC x 1 1/4"	1

## OMC/VOLVO – GM V8 Small Block Manifold



Replaces:  
 Aqua Power# 5516  
 Barr# OMC-1-914035  
 GLM# 51430  
 OMC# 914035  
       3852374  
 Osco# 52374  
 Sierra# 18-1986  
 Volvo# 3852374-2

### HGE 4035 OMC/Volvo V8 Small Block Manifold (with mounting kit)

This manifold fits Volvo 305-350 C.I.D. GM small block V8 engine, year 1994 and up.

Riser	
HGE 3784	Center riser, 4" exhaust outlet, 7° down angle.

	Mounting Kit # HGE 4035MK	
	Content	Qty
	Manifold gasket HGE 0000	1
	Riser Gasket (open) HGE 43783	1
	Bolt $\frac{3}{8}$ "-16UNC x $4\frac{3}{8}$ " + Lock Washer	6 6
	Steel Plug $\frac{3}{4}$ " NPT	2
	Steel Plug $\frac{1}{2}$ " NPT	1

OMC/VOLVO – GM V6 Manifold

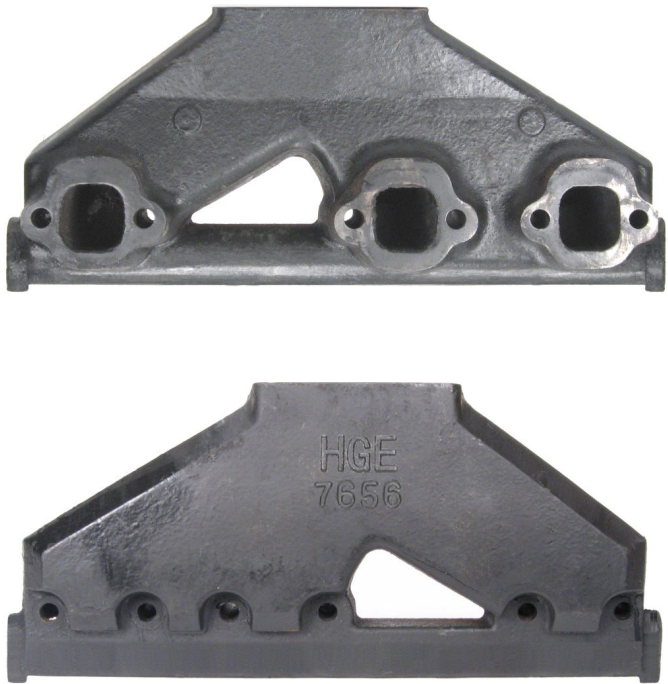

Replaces:  
Volvo# 3852338  
385756

**HGE 7656**  
**OMC/Volvo GM V6 Manifold (with Mounting kit)**

Fits Volvo v6 4.3L engine, 1995 and up, OMC v6 4.3L engine, 1991 and up.	
Fits following manifold:	
Riser	Engine
HGE 3784	Center riser, 4" exhaust outlet, 7° down angle.

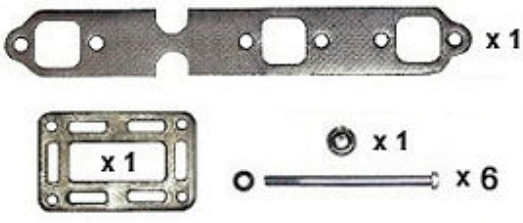

Mounting Kit # HGE 7656MK	
Content	Qty
HGE99757 - Manifold Gasket	1
HGE43783 - Riser Gasket (open)	1
Bolt 3/8"-16UNC x 4 3/8"	6
+ Lock Washer	6
Steel Plug 1/2" NPT	1

## OMC/VOLVO – GM V6, V8 Riser

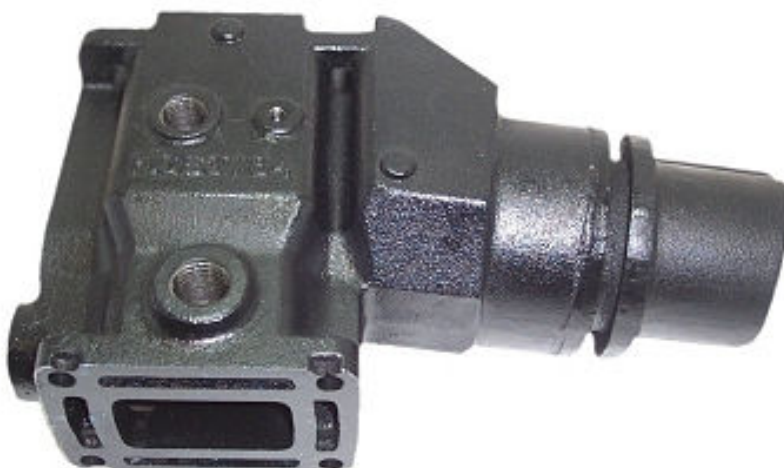

Replaces:  
 Aqua Power# 5711  
 Barr# OMC-20-913784  
 GLM# 51330  
 OMC# 913784  
       3855270  
       3850456  
 Osco# 50456  
 Sierra# 18-1909  
 Volvo# 3855270-9

### HGE 3784 OMC/Volvo Riser (with mounting kit)

Center riser, 4" exhaust outlet, 7° down angle.

This riser fits following manifolds:

Manifolds	Engine
HGE 4035	Volvo 305-350 C.I.D. GM small block V8 engine, year 1994 to 2001.
HGE 7656	Volvo V6 4.3L engine, 1995 and up, OMC V6 4.3L engine, 1991 and up.

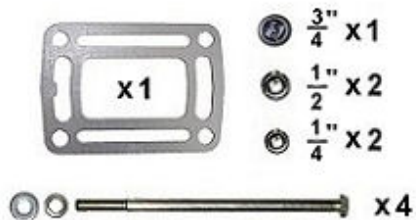

#### Mounting Kit # HGE 3784MK

Content	Qty
Riser Gasket (open) HGE 43783	1
Bolt 3/8"-16UNC x 7 3/8" + Flat Washer + Lock Washer	4 4 4
Steel Plug 3/4" NPT	1
Steel Plug 1/2" NPT	2
Brass Plug 1/4" NPT	2

## OMC/VOLVO – GM V6, V8 Riser

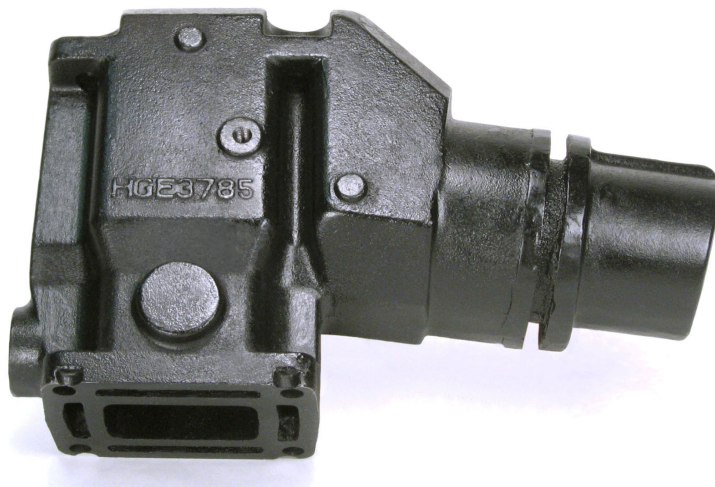

Replaces:  
 Aqua Power# 5711  
 Barr# OMC-20-913784  
 GLM# 51330  
 OMC# 913784  
       3855270  
       3850456  
 Osco# 50456  
 Sierra# 18-1909  
 Volvo# 3855270-9

### HGE 3785 OMC/Volvo Riser (with mounting kit)

Center riser, 4" exhaust outlet, 7° down angle.

This riser fits following manifolds:

Manifolds	Engine
HGE 4035	Volvo 305-350 C.I.D. GM small block V8 engine, year 1994 to 2001.
HGE 7656	Volvo V6 4.3L engine, 1995 and up, OMC V6 4.3L engine, 1991 and up.

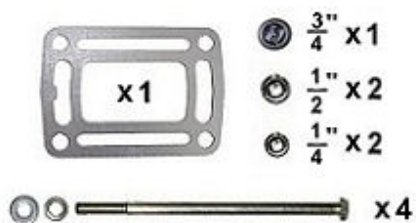

#### Mounting Kit # HGE 3785MK

Content	Qty
Riser Gasket (open) HGE 43783	1
Bolt 3/8"-16UNC x 7 3/8" + Flat Washer + Lock Washer	4 4 4
Steel Plug 3/4" NPT	1
Steel Plug 1/2" NPT	2
Brass Plug 1/4" NPT	2

**VOLVO – GM V8 Small Block Manifold**



Replaces:  
Aqua Power# 5515  
Barr# VO-1-835804  
GLM# 51630  
Marine Power# 0999-772  
Osco# 5805  
Sierra# 18-1931-1  
Volvo# 835804  
835805  
835806  
856883

**HGE 5804  
Volvo V8 Small Block Manifold (with mounting kit)**

This manifold fits Volvo GM V8 small block 305 - 350 cu. in. engines. Models AQ and BB 200, 205, 211, 231, 225, 260, 271, 290, 311, 500, 501, 570, 571 and 572.	
<b>Risers</b>	
HGE 5384	3¾"(95mm) exhaust outlet, 30° down angle riser.

	<b>Mounting Kit # HGE 5804MK</b>	
	Content	Qty
	Manifold Gasket HGE 0000	1
	Riser Gasket (open) HGE 35908	1
	Bolt 3/8"-16UNC x 5 1/8" + Lock Washer	6 6
	Steel Plug 3/4" NPT	2
	Steel Plug 1/2" NPT	1

## VOLVO – GM V8 Small Block Center Riser



Replaces:  
 Aqua Power# 5710  
 Barr# VO-20-855384  
 GLM# 51510  
 Marine Power# 0999-773  
 Osco# 56879  
 Sierra# 18-1935-1  
 Volvo# 855380  
       855384  
       856879  
       856891

### HGE 5384 Volvo Riser (with mounting kit)

3 $\frac{3}{4}$ "(95mm) exhaust outlet, 30° down angle riser.

This riser fits following manifolds:

Manifold	Engines
HGE 5804	Volvo GM V8 small block 305 - 350 cu. in. Models AQ and BB 200, 205, 211, 231, 225, 260, 271, 290, 311, 500, 501, 570, 571 and 572.

	Mounting Kit # HGE 5384MK	
	Content	Qty
	Riser Gasket (open) HGE 35908	1
	Bolt 5/16"-18UNC x 5 1/8"	2
	+ Lock Washer	2
	Bolt 5/16"-18UNC x 1 3/4"	2
	+ Lock Washer	2
	Steel Plug 3/4" NPT	1

## **VOLVO – In-line 6 Engine Manifold**

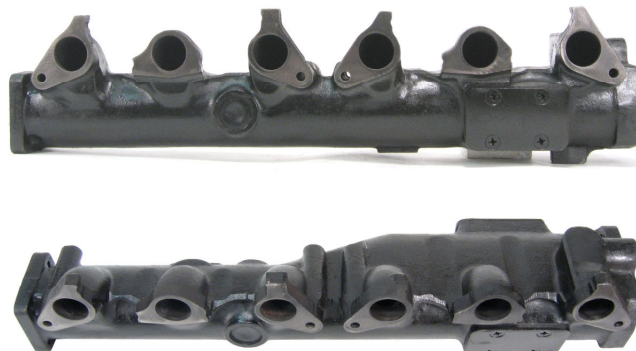

Replaces:

Volvo# 831521  
856095

### **HGE 6095 Volvo In-line 6 Manifold (without mounting kit)**

This manifold fits Volvo In-line 6 engine, model AQ165A, AQ170A, AQ170B, AQ170C.

**VOLVO – 4 Cylinder Engine Manifold**



Replaces:  
Aqua Power# 5514  
Barr# VO-1-855387  
GLM# 51610  
Osco# VO-418  
Sierra# 18-1930-1  
Volvo# 834438-4  
855387-7

**HGE 5387  
Volvo 4-Cylinder Manifold (with mounting kit)**

This manifold fits Volvo 2.3L and 2.5L 4-Cylinder engine. Models AQ120B, 125A, 131A B C D, 140A, 145A BB, 151A/B/C, 230A/B, 250A/B.

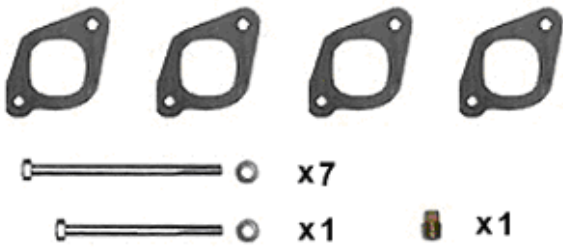
	<b>Mounting Kit # HGE 5387MK</b>	
	Content	Qty
	Manifold Gasket HGE 55383	4
	Bolt M8 x 1.25 - 130mm + Lock Washer	7 7
	Bolt M8 x 1.25 - 110mm + Lock Washer	1 1
	Brass Plug 1/4" NPT	1

**VOLVO – V6 Engine Manifold**



Replaces:

Volvo# 856894-1  
GLM# 54640  
Sierra# 18-1932

**HGE 6894**  
**Volvo V6 Manifold (with mounting kit)**

This manifold fits Volvo V-6 engine model AQ175-A.

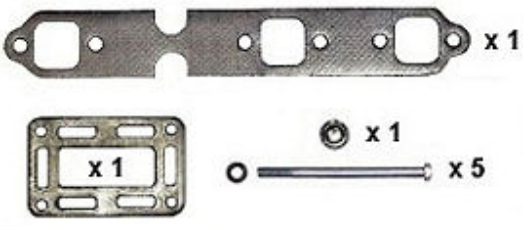
	<b>Mounting Kit # HGE 6894MK</b>	
	Content	Qty
	Manifold Gasket HGE 99757	1
	Riser Gasket (open) HGE 35908	1
	Bolt 3/8"-16UNC x 5"	5
	+ Lock Washer	5
	Steel Plug 1/2" NPT	1

**VOLVO – V6 Engine Center Riser**



Replaces:  
Volvo# 857037-6  
GLM# 51520  
Sierra# 18-1936

**HGE 7037**  
**Volvo V6 Riser (with mounting kit)**

This riser fits Volvo V-6 engine model AQ175.

	Mounting Kit # HGE 7037MK	
	Content	Qty
	Riser Gasket (open) HGE 35908	1
	Bolt 5/16"-18UNC x5¾"	2
	+ Lock Washer	2
	Bolt 5/16"-18UNC x 2½"	2
	+ Lock Washer	2
	Steel Plug ½" NPT	1

## VOLVO Penta Diesel Elbows



**HGE 9963**

Exhaust Elbow, Fits Volvo Engine  
TAMD31P/L/M, TAMD41P/M/H.

Replaces:  
Volvo# 859963



**HGE 1289**

Exhaust Elbow, Fits Volvo Engine TAMD300,  
TAMD43P, TAMD42WJ / K22.

Replaces:  
Volvo# 851289



**HGE 5261**

Exhaust Elbow, Fits Volvo Engine TAMD30,  
TAMD40, TMD40A and AQD40A

Replaces:  
Volvo# 845261, Sierra 18-4007



**HGE 8481**  
Limited supply

Fits Volvo Engine AQAD41A.

Replaces:  
Volvo# 858481

## Yanmar and Detroit Diesel Elbows



**HGE 3520**

Exhaust Elbow, Fits Yanmar 1GM, 2GM, 3GM, 1GM10, 2GM10, 3GM30, 3HM, 3HM35F.

Replaces:  
Yanmar # 124070



**HGE 1086**

Exhaust Elbow

Replaces:  
Detroit Diesel 6-71-TI Engine Exhaust Elbow

## Accessories – End Plate, Spacer



**HGE 4870**



**X 1**

**X 4**

**Mounting Kit**

End Cap/Connector (rear), Fits MerCruiser Log Style manifolds HGE 7234, 7235 and 8759, MC-1-47737, MC-37738. Package includes mounting kit.

Replaces:

Barr # 1-54870

MerCruiser # 54870

Oscos # 54870

Sierra# 18-1912

### Mounting Kit # HGE 4870MK

Content	Qty
End Gasket HGE 48043	1
Bolt 5/16"-18UNC x 1" + Lock Washer	4 4



**HGE 0252**



**X 1**

**X 4**

**Mounting Kit**

End Cap/Connector (front), 1" hose. Fits MerCruiser Log Style manifolds HGE 7234, HGE 7235 and HGE 8759. Package includes mounting kit.

Replaces:

Barr # 1-60252

GLM # 51010

MerCruiser # 60252

Oscos # 60252

Sierra# 18-4009

### Mounting Kit # HGE 0252MK

Content	Qty
End Gasket HGE 48043	1
Bolt 5/16"-18UNC x 1" + Lock Washer	4 4

## Accessories – End Plate, Spacer



**HGE 3320-PR**



**Mounting Kit**

3" Spacer Block, Fits MerCruiser manifolds HGE 7114, HGE 9746 and HGE 9011. Package includes mounting kit.

Replaces:  
Barr # MC-20-93320A3  
MerCruiser # 93320  
Osco # 3320  
Sierra# 18-1908

### Mounting Kit # HGE 3320-PRMK

Content	Qty
Riser Gasket (restrictor) HGE 41813	4
Stud $\frac{3}{8}$ "-16UNC x $1\frac{3}{4}$ "	8
+ Nut	8
+ Lock Washer	8
Steel Plug $\frac{3}{4}$ " NPT	2
Steel Plug $\frac{1}{2}$ " NPT	4



**HGE 3320A-PR**



**Mounting Kit**

3" Aluminum Spacer Block, Fits MerCruiser manifolds HGE 7114, HGE 9746 and HGE 9011. Package includes mounting kit.

Replaces:  
Barr # MC-20-93320A3  
MerCruiser # 93320  
Osco # 3320  
Sierra# 18-1908

### Mounting Kit # HGE 3320A-PRMK

Content	Qty
Riser Gasket (restrictor) HGE 41813	4
Stud $\frac{3}{8}$ "-16UNC x $1\frac{3}{4}$ "	8
+ Nut	8
+ Lock Washer	8
Steel Plug $\frac{3}{4}$ " NPT	2
Steel Plug $\frac{1}{2}$ " NPT	4

## Accessories – Tube, Damper Plate



**HGE 0092**

Aluminum Exhaust Tube.



**HGE 7K2C**

Full circle damper 13.25" diameter for 26-spline transmissions. Engines up to 430 cu. in.

Replaces: AS7K2C

Accessories – Engine Mount

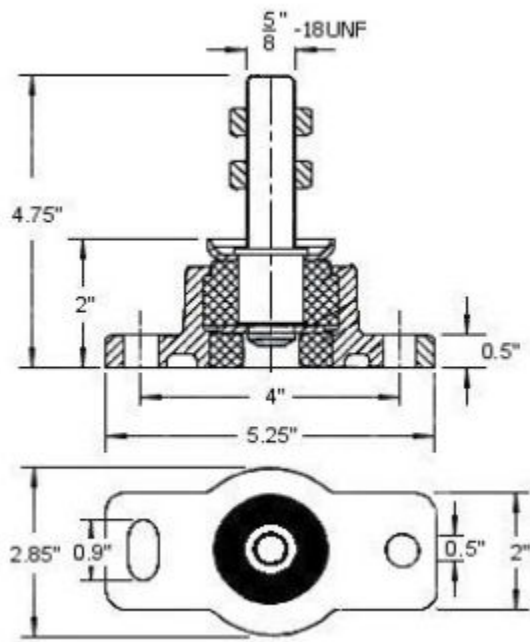

MD-1421

Engine Mount  
135 kg / 300 lb

<b>Replaces:</b>
DF-206

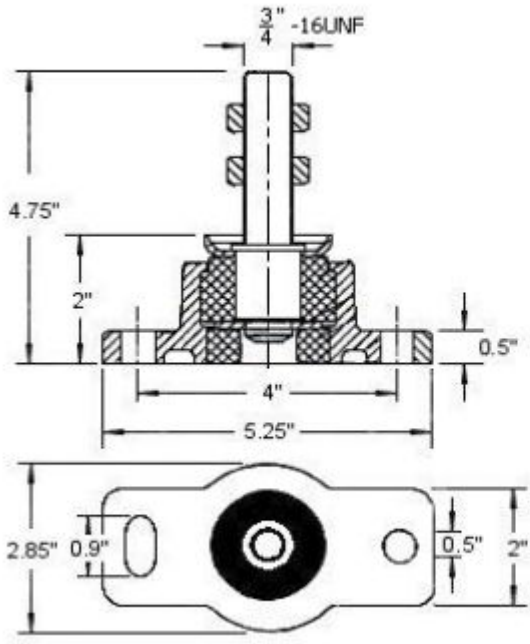

MD-1422

Engine Mount  
135 kg / 300 lb

<b>Replaces:</b>
DF-216

## Accessories – Engine Mount / Bell Housing

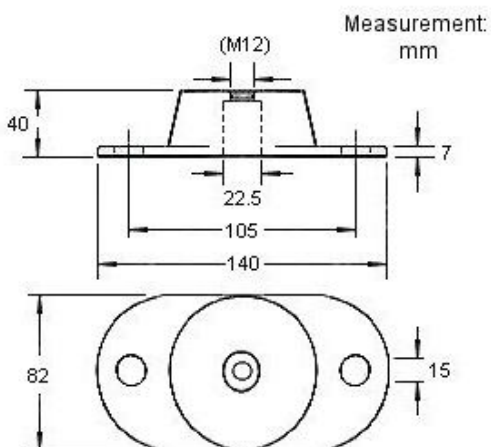

**RM520C Green**

**Engine Mount**  
55 kg / 120 lb

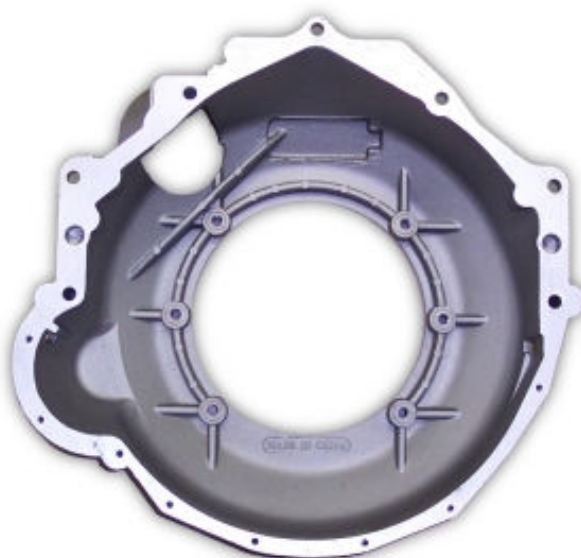

**HGE 0100-000**  
**Adaptor Bell Housing / Flywheel Housing**

Replaces: Barr MC-24-44187, 18-2434, Aqua Power 5099, Crusader 96938, MerCruiser 814309A1, Pleasurecraft R142006, Volvo Penta 3857846-4

**Supports Warner Transmissions Engine Models:**

Chevrolet 6-cylinder (in-line) 250, 292 c.i. with 14" flywheel.

Chevrolet V6 200, 201, 229 and 262 c.i. with 14" flywheel.

Chevrolet V8 265, 283, 305, 307, 327 and 350 c.i. with 14" flywheel.

Chevrolet V8 348, 396, 409, 427 and 454 c.i. with 14" flywheel.

**Accessories – Bell Housing / Water Fittings****HGE 5657**

MerCruiser Bell Housing for GM Engines

Replaces MerCruiser # 865657A04

**HGE 0045**

Stainless Steel 3/4" NPT to 1": hose fitting

45° fitting

**HGE 0090**

Stainless Steel 3/4" NPT to 1": hose fitting

90° fitting

## Products Under Development



**HGE2442 (Port) / HGE2441 (Stdbd)**

Manifold for OMC V8 283, 305, 307 & 350 cu.in. Models 185,200,225,230 and 260 H.P. Package includes mounting kit.

Replaces:

<u>Port</u>	<u>Stardboard</u>
AP # 5513	5512
Barr # OMC-1-912442	OMC-1-912441
Osc # 2242	2441
Sierra #18-1903	18-1902
OMC# 912442	909280
910144	



**HGE 2347**

Manifold for OMC 5.0L – 5.8L V8 351 Ford Sytle King Cobra Models. Package includes mounting kit.

Replaces: OMC # 3852347



**HGE 2390**

Manifold for MerCruiser 4 cylinder 184 cu.in. 140 h.p. Package includes mounting kit.

Replaces: AP # 5501,  
Barr # MC-1-52390  
MerCruiser # 52390 and 96705  
Osc # 6705  
Sierra # 18-1955-1



**HGE 4221**

Manifold (port), fits OMC V-6, MerCruiser V-6. Package includes mounting kit.

Replaces OMC # OMC-1-984221  
GLM # 51470

**Products Under Development**



**HGE 4222**

Manifold (starboard), fits OMC V-6, Mercrusier V-6. Package includes mounting kit.

Replaces OMC # OMC-1-984222  
GLM # 51472

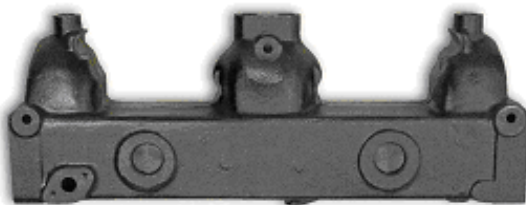

**HGE 4532**

Volvo 4-Cylinder Manifold

Replaces: Barr# VO-1-824532  
Volvo# 824532-6



**Mount Kit**

<b>Mounting Kit # HGE 4532MK</b>	
Content	Qty
Manifold Gasket HGE 56044	1
Riser/End Gasket HGE 56028	2
Bolt 5/16"-18UNC x 4 1/2" + Lock Washer	2 2
Stud 5/16" x 3" + Nut + Lock Washer	1 1 1

## Products Under Development

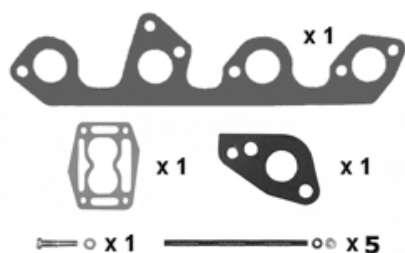
**HGE 6041****Mounting Kit**

OMC 2.3L Exhaust Manifold

Replaces: OMC# 912472, 913395, 986041

### **Mounting Kit # HGE 6041MK**

Content	Qty
Manifold Gasket HGE 913393	1
Riser Gasket HGE 912477	1
T-Housing Gasket HGE 912478	1
Bolt M10x1.5, 40mm + Lock Washer	1 1
Stud M10x1.5, 170mm (thread length one end 35mm; one end 20mm) + Lock Washer + Nut	5 5 5

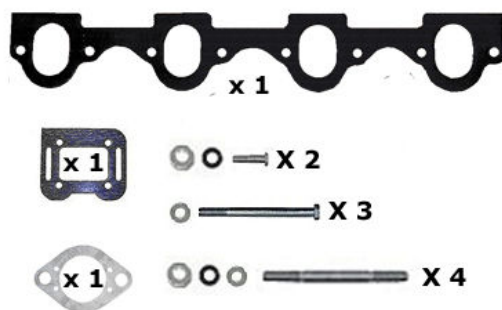
**HGE 6219-A****Mounting Kit**

MerCruiser 470 Aluminum Exhaust Manifold

Replaces: MerCruiser# 816219

### **Mounting Kit # HGE 6219-AMK**

Content	Qty
Manifold Gasket HGE 68715	1
Riser Gasket HGE 88562	1
T-Housing Gasket HGE 89656	1
Bolt 3/8"-16UNC x 1 1/2" + Lock Washer + Flat Washer	2 2 2
Bolt 3/8"-16UNC x 6" + Lock Washer	3 3
Stud 7" long, (One end 3/8"-16UNC; One end 3/8"-16UNF) + Flat Washer + Lock Washer + Nut	4 4 4 4

Products Under Development

<div><p><b>HGE2076</b></p><p><b>Mounting Kit</b></p><p>X 1 X 2</p></div>	<p>Riser for Manifold HGE 2390 Package includes mounting kit.</p> <p>Replaces: AP # 5726 Barr # MC-20-12076 MerCruiser# 12076 Oscos # 2076 Sierra # 18-1975</p> <table><tr><th colspan="2">Mounting Kit # HGE 2076MK</th></tr><tr><th>Content</th><th>Qty</th></tr><tr><td>Riser Gasket (open) HGE 99777</td><td>1</td></tr><tr><td>Bolt 3/8"-16UNC x 2 1/2" (thread 1") + Lock Washer</td><td>2</td></tr></table>	Mounting Kit # HGE 2076MK		Content	Qty	Riser Gasket (open) HGE 99777	1	Bolt 3/8"-16UNC x 2 1/2" (thread 1") + Lock Washer	2
Mounting Kit # HGE 2076MK									
Content	Qty								
Riser Gasket (open) HGE 99777	1								
Bolt 3/8"-16UNC x 2 1/2" (thread 1") + Lock Washer	2								
<div><p><b>HGE2680</b></p></div>	<p>Riser for Manifold HGE2242 and HGE2241. Package includes mounting kit.</p> <p>Replaces: AP # 5708 Barr # MC-20-982680 Oscos # 9863 Sierra # 18-1921 OMC # 982680</p>								

## Products Under Development

**HGE 3394**

x 1



x 2

x 2

**Mounting Kit**

Riser for HGE3784 Manifold.  
Package includes mounting kit.

Replaces: OMC # 913394

**Mounting Kit # HGE 3394MK**

Content	Qty
Riser Gasket HGE 912477	1
Bolt $\frac{3}{8}$ "-16UNC x 5" + Lock Washer	2 2
Bolt $\frac{3}{8}$ "-16UNC x 1½" + Lock Washer	2 2

**HGE 6351-A**

x 1



x 1

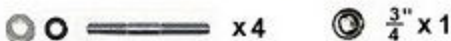

x 4

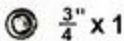
 $\frac{3}{4}$ " x 1**Mounting Kit**

Aluminum MerCruiser Log Riser

Replaces: Aqua Power# 5701  
Barr# MC-20-60426,  
MC-20-76351  
GLM# 51120  
Marine Power# 0993-001  
MerCruiser# 76351, 60426,  
49964  
Osco# 6351  
Sierra# 18-1971

**Mounting Kit # HGE 6351-AMK**

Content	Qty
Riser Gasket (open) HGE 52076	1
Riser gasket (close) HGE 92720	1
Stud $\frac{3}{8}$ " x 1¾" + Nut + Lock Washer	4 4 4
Stainless Steel Plug $\frac{3}{4}$ " NPT	1

**Products Under Development**



**HGE 1163**

Exhaust Ben for HGE6095 Manifold. Package includes mounting kit.

Replaces: Volvo # 831163



**HGE 5599**

Volvo 4-Cylinder Exhaust Bend

Replaces: Barr # VO-20-825599

Volvo # 825599-4



**x1**



**x 4**

**Mounting Kit**

**Mounting Kit # HGE 5599MK**

Content	Qty
Riser/End Gasket HGE 56028	1
Bolt 7/16"-14UNC x 1" + Lock Washer	4
	4



**HGE 1070**

Volvo Forward End Cover for HGE6095 Manifold. Package includes mounting kit.

Replaces: Volvo # 831070

**Products Under Development****HGE 0372**

Upper Thermostat Housing for MerCruiser 120, 140, 120R/140R, 160, 165 and 200 Engines. Package includes mounting kit.

Replaces: Barr # MC-29-60372

**HGE 7441**

Upper Thermostat Housing for MerCruiser 185R, 225(GM), 228, 260, 898/198, 898R/228R/260R Engines. Package includes mounting kit.

Replaces: Barr # MC-29-47441

**HGE 8984**

Lower Thermostat Housing for MerCruiser 225, 228, 260, 898/198. Package includes mounting kit.

Replaces: Barr # MC-29-78984

Products Under Development



HGE 3621-PR



Mounting Kit

Volvo / OMC Penta 3" Spacer

Replaces:

Mounting Kit # HGE 3621-PRMK	
Content	Qty
Riser Gasket (open) HGE 43783	4
Stud 3/8"-16UNC x 1 3/4"	8
+ Nut	8
+ Lock Washer	8
Steel Plug 1/8" NPT	4



HGE 5528



Mounting Kit

Volvo Water Connector for Volvo Elbow Penta Diesel # AQAD40, AQAD40B, TAMD40A, TAMD40B

Replaces: Volvo # 845528

Mounting Kit # HGE 5528MK	
Content	Qty
Gasket HGE 845527	1
M8 Hex Socket Head Cap Screw x 18mm	2

## Installation Examples – Center Riser Manifold



### Center Riser Exhaust System - Open (Raw Water) Cooling

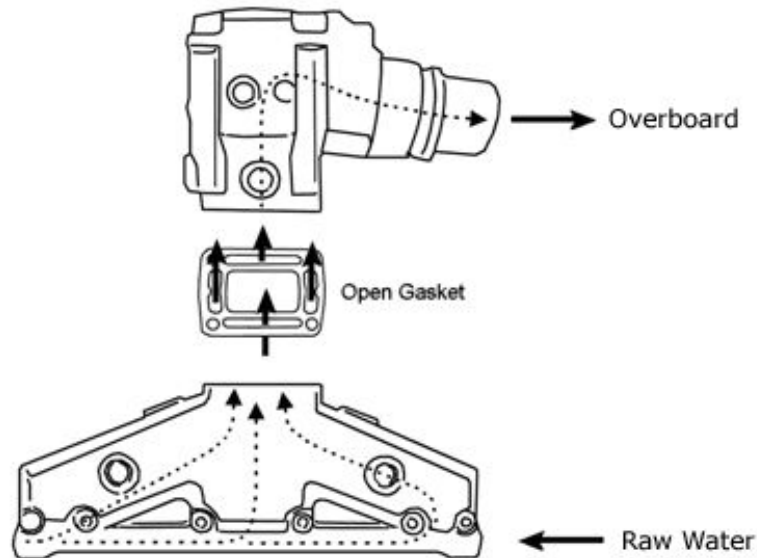

### Center Riser Exhaust System - Closed (Fresh Water) Cooling

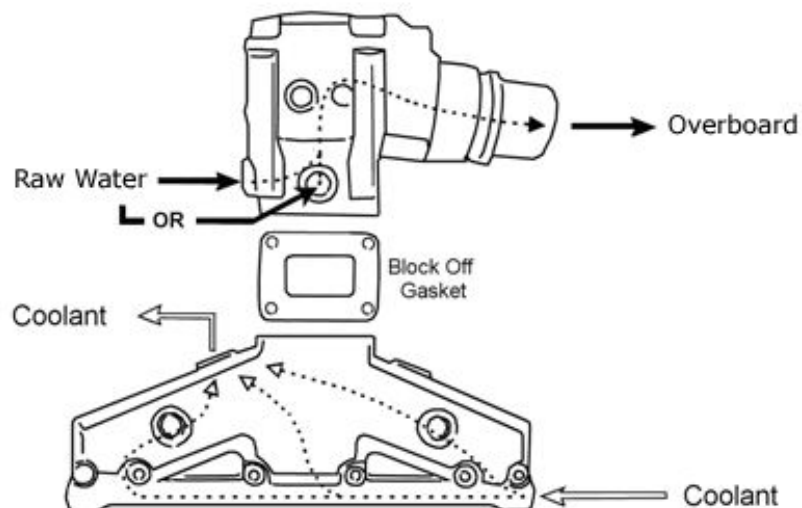

#### Remarks:

1. The riser and manifold bolts must first be tightened. The recommended torque range is 25-28 foot-pounds. Next, warm up the engine for 5 min., then turn off the engine and re-torque the bolts to ensure proper installation of the bolts.
2. The application of your engine may differ from the illustration shown above; please consult your mechanic for more information.

## Installation Examples – Log Style Manifold



### Log Style Exhaust System - Open (Raw Water) Cooling

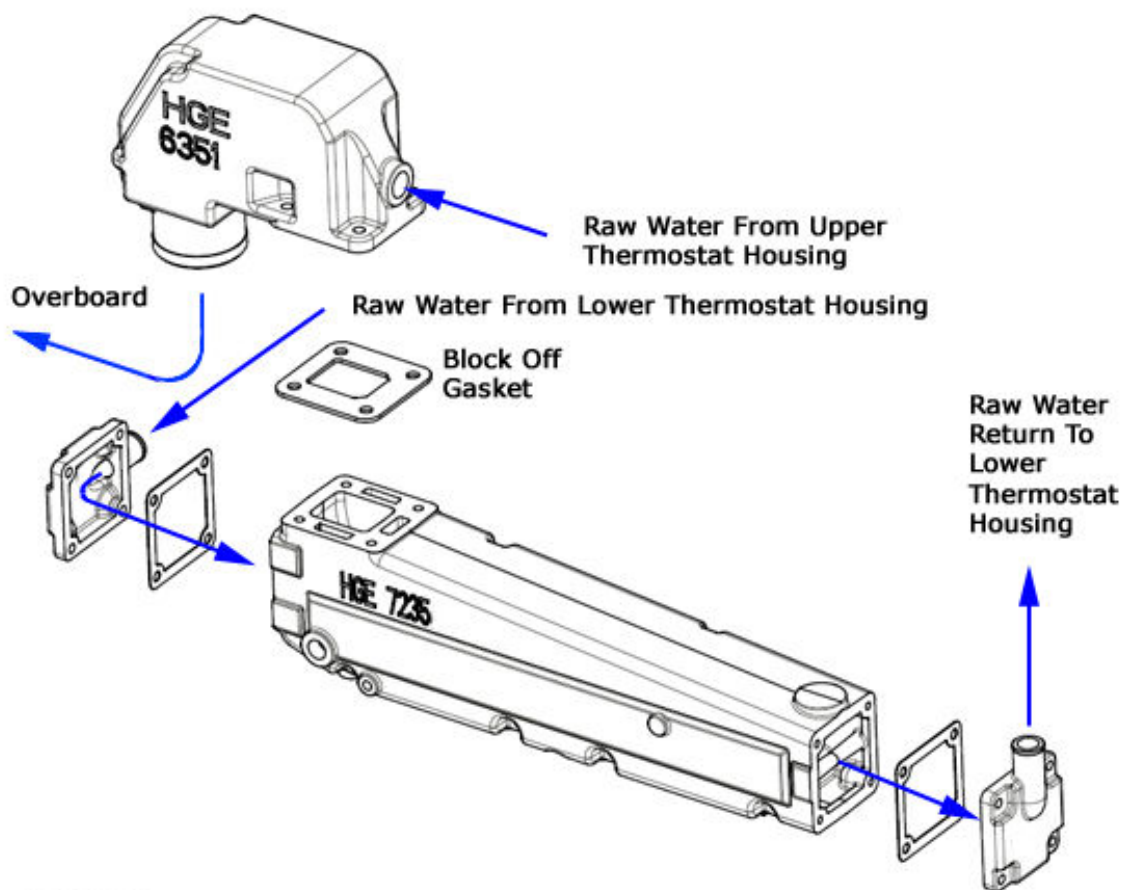

## Remarks:

1. The riser and manifold bolts must first be tightened. The recommended torque range is 25-28 foot-pounds. Next, warm up the engine for 5 min., then turn off the engine and re-torque the bolts to ensure proper installation of the bolts.
2. The application of your engine may differ from the illustration shown above; please consult your mechanic for more information.

## Installation Examples – Log Style Manifold



### Log Style Exhaust System - Closed (Fresh Water) Cooling (Option 1 - Spacer Used)

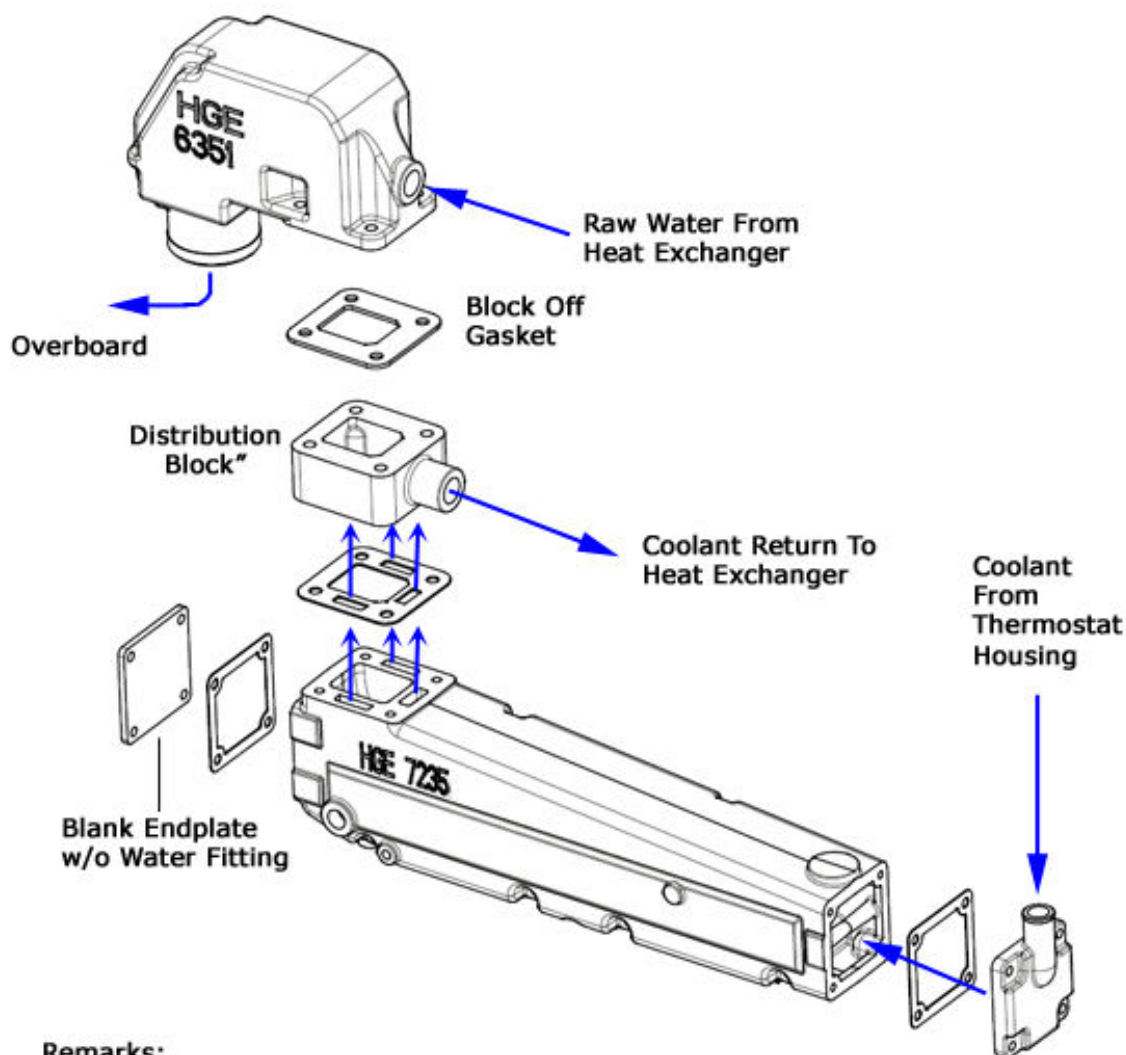

#### Remarks:

1. The riser and manifold bolts must first be tightened. The recommended torque range is 25-28 foot-pounds. Next, warm up the engine for 5 min., then turn off the engine and re-torque the bolts to ensure proper installation of the bolts.
2. The application of your engine may differ from the illustration shown above; please consult your mechanic for more information.

## Installation Examples – Log Style Manifold



### Log Style Exhaust System - Closed (Fresh Water) Cooling (Option 2 - Spacer Not Used)

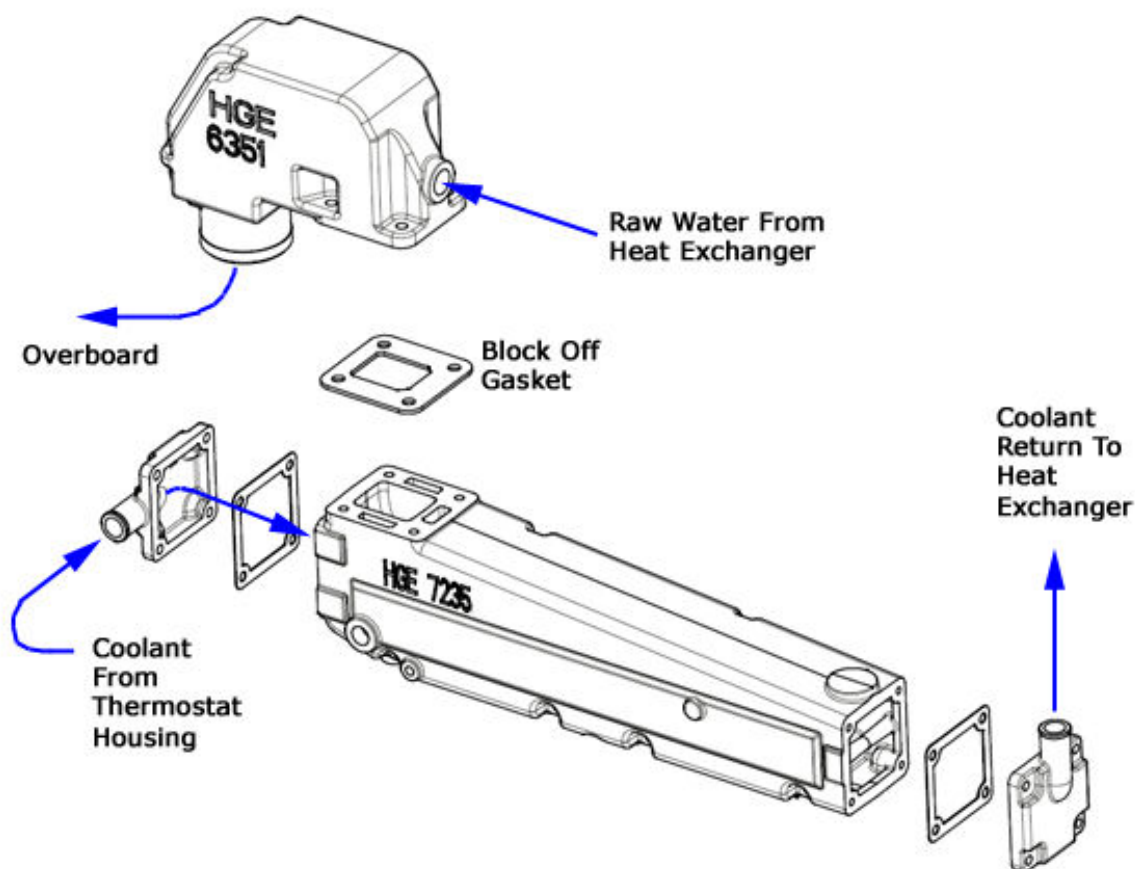

#### Remarks:

1. The riser and manifold bolts must first be tightened. The recommended torque range is 25-28 foot-pounds. Next, warm up the engine for 5 min., then turn off the engine and re-torque the bolts to ensure proper installation of the bolts.
2. The application of your engine may differ from the illustration shown above; please consult your mechanic for more information.

## Installation Examples – Log Style In-line 6 Manifold



### Log Style Exhaust System - Open (Raw Water) Cooling

HGE 8759 - MerCruiser Straight 6-Cylinder 164 h.p.

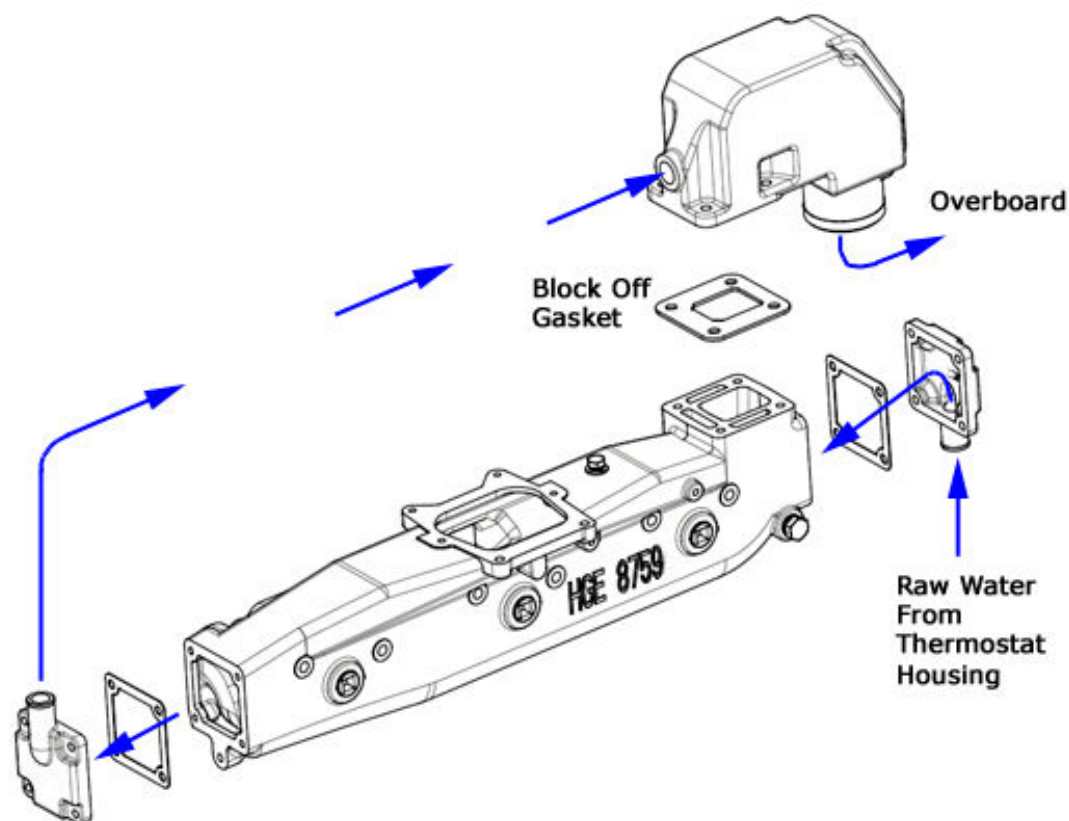

#### Remarks:

1. The riser and manifold bolts must first be tightened. The recommended torque range is 25-28 foot-pounds. Next, warm up the engine for 5 min., then turn off the engine and re-torque the bolts to ensure proper installation of the bolts.
2. The application of your engine may differ from the illustration shown above; please consult your mechanic for more information.

## Installation Examples – Log Style In-line 6 Manifold



### Log Style Exhaust System - Closed (Fresh Water) Cooling

HGE 8759 - MerCruiser Straight 6-Cylinder 164 h.p.

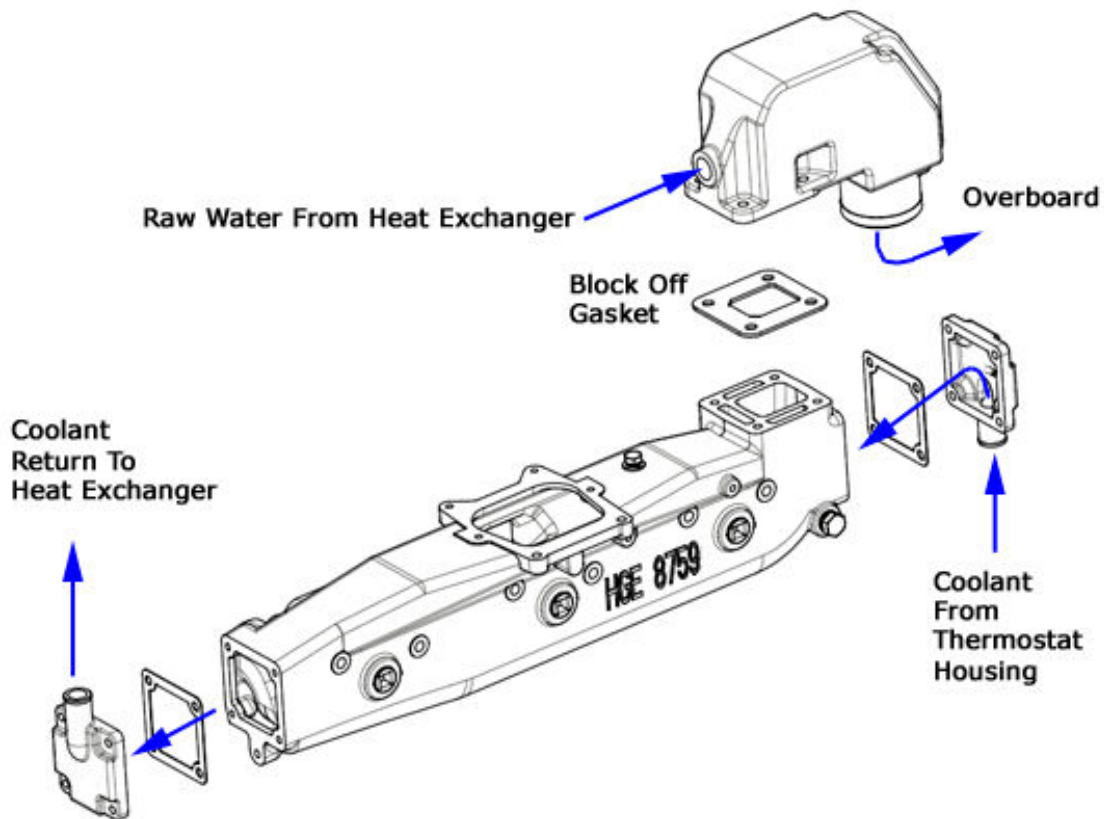

#### Remarks:

1. The riser and manifold bolts must first be tightened. The recommended torque range is 25-28 foot-pounds. Next, warm up the engine for 5 min., then turn off the engine and re-torque the bolts to ensure proper installation of the bolts.
2. The application of your engine may differ from the illustration shown above; please consult your mechanic for more information.

## **H & H Marine Engine Service Ltd.**

### **Head Office:**

7002 MacPherson Ave, BC V5J 4N3 Canada  
Phone : +1-604-291-9888  
Fax : +1-604-291-9801  
Email : [sales@hgemarine.com](mailto:sales@hgemarine.com)